

When the box is being loaded the main portal screen appears. press remote button

**“SETUP/SET”**

After that click on **“Setting”**



Then press on **“System Settings then Click on “Servers”**

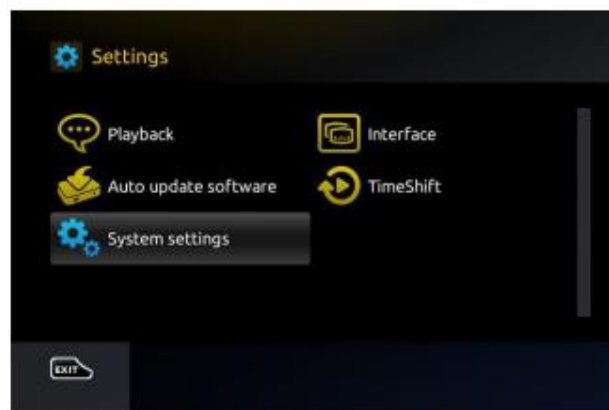

Select now **“Portals”**

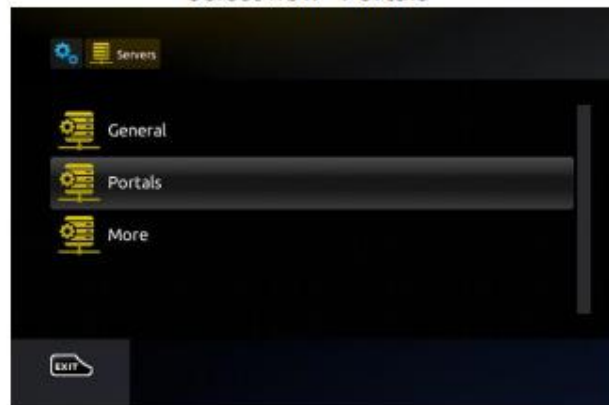

Step 4:  
In the "Portal 1 name"  
line enter the following

**TrupinaTV**

In the "Portal 1 URL"  
enter

**<http://mag.trupinatv.hitv.one/c/>**

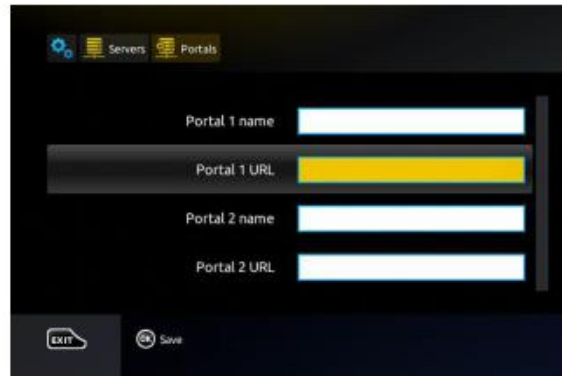

Step 5: When all the operations listed above is done, then press "OK".  
When the settings are being saved click "EXIT" on the remote control and press option  
"General".

In the "NTP server," line enter the following address "pool.ntp.org"

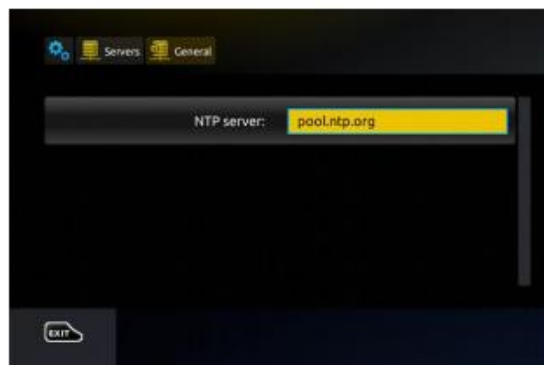

Press "OK" to save the changes you made.  
When all the steps listed above are done press "EXIT" 2 times on the remote control and  
restart the portal.  
Now everything is ready to start watching Live TV =)